

With your PT-D200/E200, you can create labels for multiple applications. Select from the many frames, character sizes and styles to design beautiful custom labels. In addition, the variety of tape cartridges available allows you to print labels with different widths and exciting colours.

Printed in China
LAD388001

Safety Precautions

WARNING Indicates a potentially hazardous situation which, if not avoided, could result in death or serious injuries.

Follow these guidelines to avoid the risk of fire, burns, injury, electric shocks, rupture, overheating, abnormal odours or smoke.

- Always use the specified voltage and the recommended AC adapter (AD-24ES UK: Optional on the PT-D200) for the P-touch labeller to prevent any damage or failure.
- Do not touch the P-touch labeller during a lightning storm.
- Do not use the machine/AC adapter in places of high humidity (such as bathrooms).
- Do not overload the power cord.
- Do not place heavy objects on, or damage the power cord or plug. Do not forcibly bend or pull the power cord. Always hold the AC adapter carefully when disconnecting from the power outlet.
- Make sure that the plug is fully inserted in the power outlet. Do not use an outlet that is loose.
- Do not allow the machine/AC adapter/power plug/batteries to get wet, for example, by handing them with wet hands or spilling beverages onto them.
- Since loss of eyesight may result when leaked fluid from batteries gets into your eyes, immediately rinse your eyes with a large amount of clean water, and then seek medical attention.
- Do not disassemble or modify the P-touch labeller/AC adapter/batteries.
- Do not allow a metal object to contact both the plus and minus ends of a battery.
- Do not use sharp objects, such as tweezers or a metallic pen, to change the batteries.
- Do not throw the batteries into fire or expose to heat.
- Disconnect the AC adapter, remove batteries immediately and stop using the machine if you notice abnormal odour, heat, discoloration, deformation or anything unusual while using or storing it.
- Do not use a damaged or leaking battery as the fluid may get on your hands.
- Do not use a deformed or leaking battery or one whose label is damaged. There is a possibility of generating heat.

• Only use a soft, dry cloth to clean the labeller, never touch the organic solvents.

• Use a soft wipe to clean the print head; never touch the print head.

• Do not put any foreign objects into the tape exit slot or AC adapter connector or battery compartment, etc.

• Do not place the P-touch labeller/batteries/AC adapter in direct sunlight or rain, near heaters or other hot appliances, in any location exposed to extremely high or low temperatures (e.g., on the dashboard or in the back of your car) or high humidity, or in dusty locations.

• Do not apply excessive pressure to the cutter lever.

• Do not try to print if the cassette is empty, it will damage the print head.

• Do not pull the tape while printing or feeding; it will damage the tape and machine.

• Any data stored in memory will be lost due to failure or repair of the P-touch labeller, or if the battery expires.

• The P-touch labeller is not equipped with a charging feature for rechargeable batteries.

• A protected text may differ from the text that appears on the LCD.

• The length of the printed label may differ from the displayed label length.

• A printed clear plastic sticker is placed over the display during manufacturing and shipping. This sticker should be removed prior to use.

• When power is disconnected for more than three minutes, all text, format settings and any text files stored in the memory will be cleared.

CAUTION Indicates a potentially hazardous situation which, if not avoided, may result in minor or moderate injuries.

Follow these guidelines to avoid personal injury, liquid leakage, burns or heat.

- When the machine is not being used, store it out of the reach of children. In addition, do not allow children to put machine parts or labels in their mouths. If any object has been swallowed, seek medical attention.
- Do not touch metal parts near the print head immediately after printing.
- Do not touch the cutter blade.
- If leaked fluid from batteries gets onto your skin or clothes, immediately rinse them with clean water.
- Remove the batteries and disconnect the AC adapter if you do not intend to use the P-touch labeller.
- Do not use a battery other than that specified. Do not use combinations of old and new batteries or combinations of different types, different charging levels, different manufacturers or different models. Do not insert a battery with its plus and minus ends reversed.
- Do not drop or hit the P-touch labeller/AC adapter.
- Do not press on the LCD display.
- Do not put your finger inside the machine when you close the back cover.
- Before using Ni-MH rechargeable batteries, carefully read the instructions for the batteries and battery charger, and be sure to use them correctly.
- When using Ni-MH rechargeable batteries, charge the batteries with a specialized battery charger before using the batteries.

General Precautions

Depending on the location, material, and environmental conditions, the label may unpeel or become irremovable, the colour of the label may change or be transferred to other objects. Before applying the label, check the environmental conditions and the material.

Do not use the P-touch labeller in any way or for any purpose not described in this guide. Doing so may result in accidents or damage to the machine.

Use only Brother TZe tapes with the P-touch labeller. Do not use tapes that do not have the TZe mark.

Licensed Trademarks

Monotype™
Monotype is a trademark of Monotype Imaging Inc. registered in the United States Patent and Trademark Office and may be registered in certain other jurisdictions.

Frutiger™
Frutiger is a trademark of Linotype Corp. registered in the U.S. Patent and Trademark Office and may be registered in certain other jurisdictions in the name of Linotype Corp. or its licensee Linotype GmbH.

Palatino™
Palatino is a trademark of Linotype GmbH registered in the U.S. Patent and Trademark Office and may be registered in certain other jurisdictions.

BASIC USAGE

Entering Text

Switching the character for entry[English/Arabic]

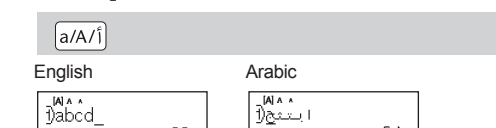

Switching Upper Case/Lower Case

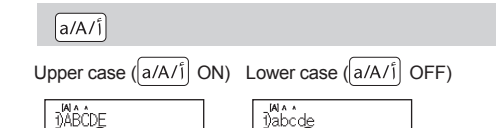

Making Two Lines of Text

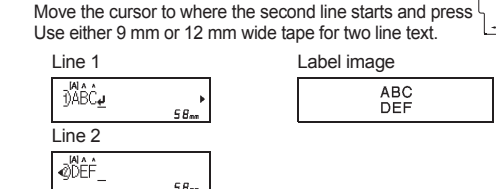

NOTE
The return symbol (μ) will be displayed when the Enter key is pressed.

Printing Labels

Preview

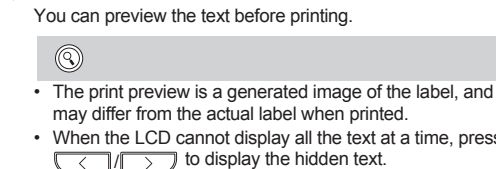

Feeding (Tape Feed)



Printing

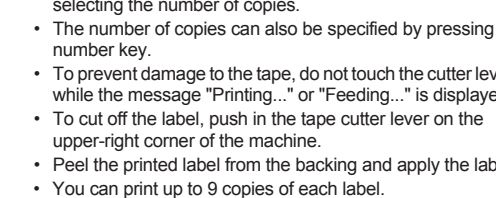

Using Print Options

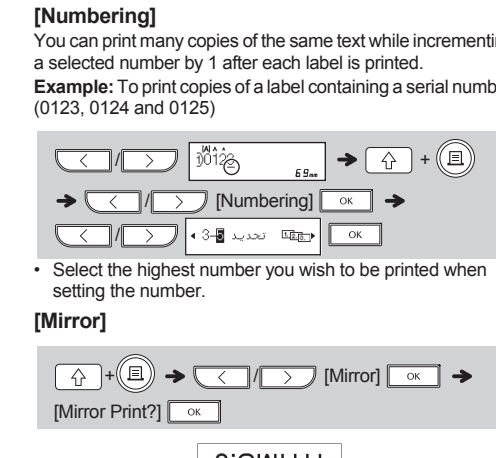

NOTE
The machine automatically turns off if no keys are pressed within five minutes.
To cancel any operation, press [Esc].

Saving Label Files

You can save up to 9 labels and recall them for printing at a later date. A maximum of 80 characters can be saved per file. You can also edit and overwrite stored labels.

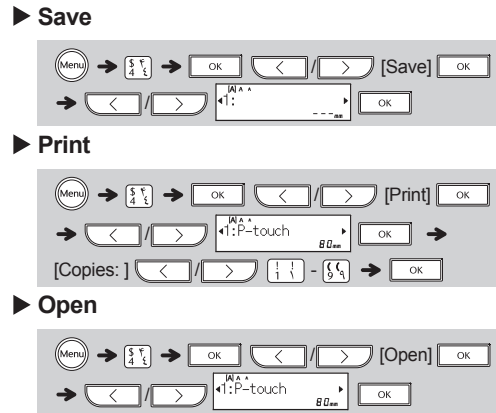

NOTE
If you try to store a label when there is already a label stored that that number, a message "Overwrite?" will appear. Press [OK] to save your new label. Press [Esc] to cancel.

Entering Accented Characters

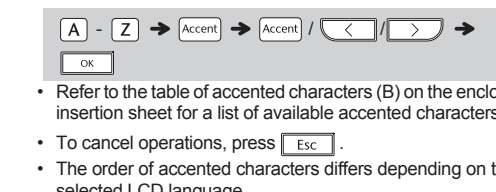

Changing Label Length

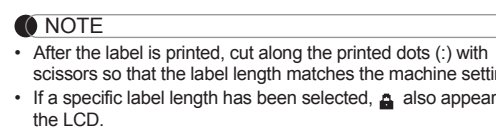

To Clear
By pressing [C], the letters will be deleted one by one. To delete all text and settings:

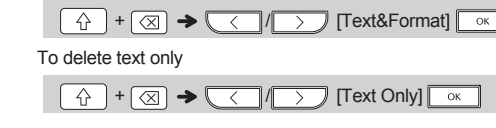

Setting Margin

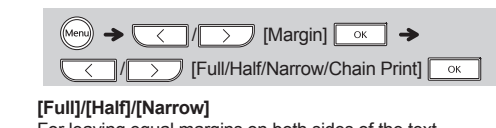

[Full]/[Half]/[Narrow]
For leaving equal margins on both sides of the text.

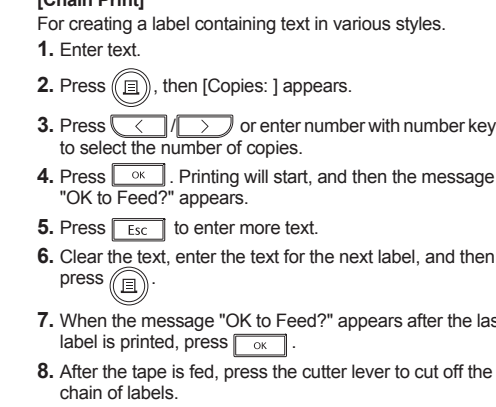

NOTE
When [Chain Print] is set, feed the tape before using the cutter otherwise a part of the text may be cut off. Also, cut along the printed dots (·) with scissors so the text is centred in the label.

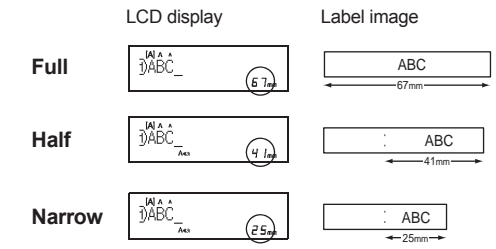

To print more than 1 copy of a label with the minimum margin, set the margin to [Narrow].
Do not pull the tape since this may damage the tape cassette.

Accessories

Tape Cassettes: See the included "Tape Catalog".
AC Adapter: AD-24ES UK
Carrying Case: This accessory is only included in the PT-E200.
Cutter Unit: TC-4 (replacement)

If the cutter blade becomes blunt after repetitive use and the tape cannot be cut cleanly, replace with a new cutter unit (stock no. TC-4) obtained from an authorised Brother reseller.

Replacing the Cutter Unit
1. Pull out the two sections of the cutter unit (green) in the direction of the arrows shown in the illustration.

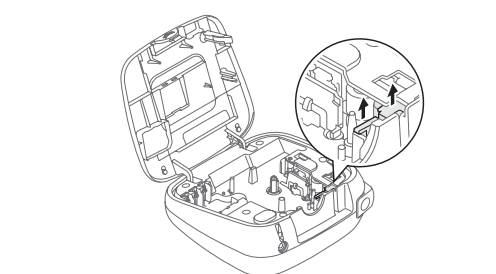

2. Install a new cutter unit. Push it in until it snaps into place.

Do not touch the cutter blade directly with your fingers.

USING TEMPLATES

Name Label

This function allows you to create various name labels using the built-in templates. Refer to the Name Label format table (A) on the enclosed insertion sheet.

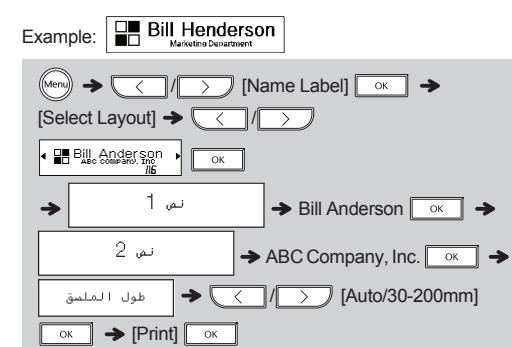

NOTE
After the label is printed, cut along the printed dots (·) with scissors so that the label length matches the machine setting.
If a specific label length has been selected, a also appears in the LCD.

To Clear
By pressing [C], the letters will be deleted one by one. To delete all text and settings:

To clear all text, press [C] and [C], then "Clear?" appears. Press [OK] to clear. Press [Esc] to cancel.

When you access Decorative Mode or Name Label function, your most recently printed Decorative Mode or Name Label function text and label length will be recalled.

Press [Esc] to return to the previous step.

USEFUL FUNCTION KEYS

Font Key

1 Press [A/A] to select the settings to enter text.

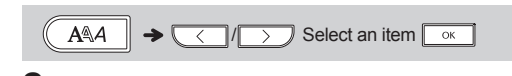

2 Press [Left/Right] to select the settings.

Font	A A	Helsinki (Frutiger™)	ا ا
		Brussels (Palatino™)	ا ا
		Florida (Frutiger™)	ا ا
		Calgary (Palatino™)	ا ا
Size	A A A	Large	A
		Medium	A
		Small	A
Width	A A	Normal	A
		x 2	A
		x 1/2	A
Style	A A	Normal	A
		Bold	A
		Outline	A
		Shadow	A
		Solid	A
		Italic	A
		I+Bold	A
		I+Outline	A
		I+Shadow	A
		Vertical	A

NOTE
To cancel operations, press [Esc].
The actual printed font size depends on the tape width, number of characters and number of input lines. Once characters reach a minimum size, the selected font will default to a custom font which is based on the Helsinki style. This allows labels to print using the smallest text possible on narrow or multi-line labels.

Frame Key

Press [ABC] to select the frame design. Refer to the frame design table (B) on the enclosed insertion sheet.

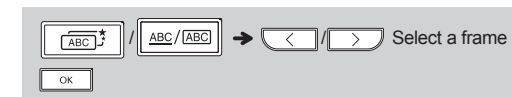

To cancel operations, press [Esc].

Decorative Mode (Does not support Arabic text.)

This function allows you to create unique labels by using built-in templates. Refer to the Decorative Mode format table (C) on the enclosed insertion sheet.

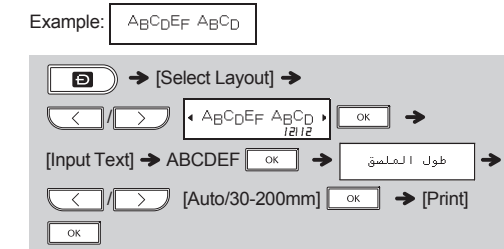

To exit the Decorative Mode or Name Label function and return to the text input screen, do one of the following:
a) Press [Esc].
b) Press [Left/Right] to select [Cancel], and then press [OK] when "Print" appears.

These features are only available when using 12 mm wide tape cassettes.
The maximum label length is 200 mm for Decorative Mode and Name Label function.
When [Auto] is selected for "Label Length", the label will automatically adjust to the correct length for the text.
Press [Left/Right] to return to the [Auto] setting for "Label Length" mode.

Symbol Key

Press [Symbol] to select various symbols. Refer to the table of symbols (D) on the enclosed insertion sheet for a list of available symbols.

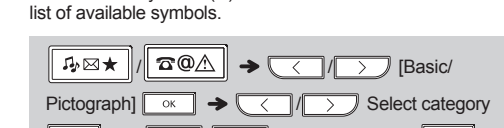

To cancel operations, press [Esc].

Resetting the P-touch

You can reset the P-touch labeller when you want to initialise the settings, or in the event the P-touch labeller is not working properly.

1 Turn off the P-touch labeller, hold down [Up] and [Right] and then press [Power] to turn the P-touch back on.

2 Release [Up] and [Right].
The P-touch labeller turns on with the internal memory reset.

NOTE
All text, settings and stored files are cleared.

Specifications

Dimensions: (W x D x H) Approx. 165(W) x 155(D) x 68(H)mm
Weight: Approx. 490 g (without batteries and tape cassette)
Power supply: Six AAA alkaline batteries (LR03) Six AAA Ni-MH batteries (HR03)^{*1} AC adapter (AD-24ES UK: Optional on the PT-D200)
Tape cassette: Brother TZe tape (width) 3.5 mm, 6 mm, 9 mm, 12 mm

^{*1} Visit us at <http://solutions.brother.com/> for the latest information about the recommended batteries.

Power Supply and Tape Cassette

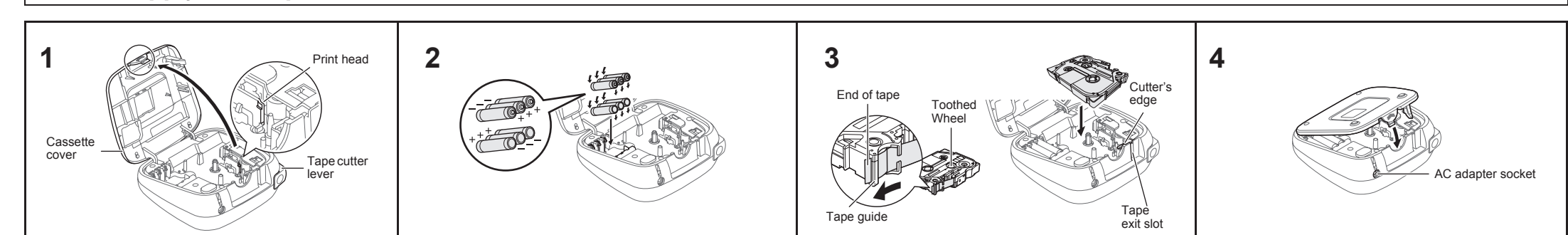

Open the cassette cover by pressing the above indicated area at the top end of the machine.

If a tape cassette is already installed, remove it by pulling it straight up. Also, if batteries are already installed, remove them.

Make sure that the power is turned off when replacing batteries or tape cassettes.

Insert six new AAA alkaline batteries (LR03) or fully charged Ni-MH batteries (HR03), making sure that their poles point in the correct directions.

Users of alkaline batteries:
Always replace all six batteries at the same time with brand new ones.

Users of Ni-MH batteries:
Always replace all six batteries at the same time with fully charged ones.

NOTE
Visit us at <http://solutions.brother.com/> for the latest information about the recommended batteries.

Insert a tape cassette, making sure that it snaps into place.

- Make sure that the end of the tape feeds under the tape guides.
- Use only Brother TZe tapes with this machine.

Securely close the cassette cover, making sure that it snaps into place.

NOTE
When using AC adapter (AD-24ES UK: Optional on the PT-D200)

- Connect the AC adapter into the AC adapter socket on the top of the machine.
- Insert the plug into the nearest standard electrical outlet.

For memory back up, we recommend using AAA alkaline batteries (LR03) or Ni-MH batteries (HR03) together with the AC adapter.

LCD Display & Keyboard

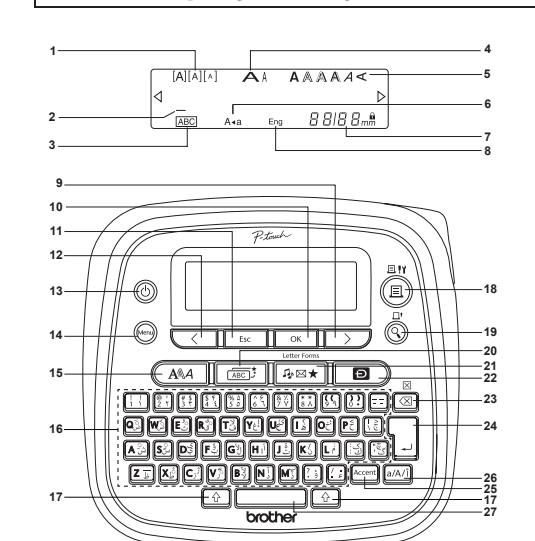

- Size
- Cursor
- Underline/Frame
- Width
- Style
- Caps
- Label Length
- Cursor key: Right (Use with Shift key to go to end of the text.)
- OK key
- Escape key
- Cursor key: Left (Use with Shift key to go to top of the text.)
- Power key
- Menu key
- Font key
- Character keys
- Shift keys
- Print key
- Preview key
- Frame key
- Symbol key
- Decorative Mode key
- Backspace key
- Enter key
- Accent key
- Eng/Arabic key
- Space key

NOTE
The LCD shows one row of 15 characters; however, the text that you enter can be up to 80 characters in length.
While selecting the settings, press the Space key to go back to the default item.

The print preview is a generated image of the label, and may differ from the actual label when printed.
Label length shown on LCD may slightly differ from the actual label length when printed.

Initial Settings

1 Start your machine.
Supply power by using six AAA batteries or the AC adapter (AD-24ES UK: Optional on the PT-D200), and then press [Power].

2 Set the language.
The default setting is [English].

3 Set the unit of measurement.
The default setting is [mm].

NOTE
The machine automatically turns off if no keys are pressed within five minutes.
To cancel any operation, press [Esc].

Troubleshooting

Message	Cause/Remedy
No Cassette!	You tried to print a label when there is no cassette installed.
Cutter Error!	The tape cutter lever was used in the middle of the printing process.
Text Full!	The maximum number of characters (80 characters, 50 characters for Decorative Mode or Name Label function) have already been entered.
Text Limit!	With the Decorative Mode or Name Label function: Since the number of entered characters exceeds the label length, reduce the text. All other functions: Since the number of entered characters exceeds the label length, reduce the text, or select [Auto] as the label length.
No Frame OK?	Printing on 3.5 mm tape with invalid Frame setting ON. (Select [OK] to print with no Frame, [Esc] to cancel.)
No VRT OK?	Vertical (or Italic) printing is impossible if entry was made in Arabic characters.
No Italic OK?	
OK to Feed?	Feeding tape after printing when [Chain Print] is selected. Refer to "Setting Margin".
Insert 12mm!	Only 12 mm tapes are available for use with Decorative Mode or the Name Label function.
Wrong Tape!	Use a tape cassette with the TZe mark.
Low Battery!	The batteries are weak. If using AAA alkaline batteries: Replace them with new ones. If using Ni-MH batteries: Charge them fully.
Battery Dead!	The installed batteries are running low.
Invalid!	There is no text above the cursor when you selected [Numbering]. An invalid character was selected for [Numbering]. An invalid number was selected for [Tab Length] or [Label Length]. An invalid value was entered as the label length while using the Decorative Mode or Name Label function. When the vowel key which cannot be compound is pushed.
No Text!	You tried to print a text file when there is no data stored in the memory. [C] is pressed when no text is entered. You tried to select [Numbering], [Mirror], or Text Preview when no text is entered. [OK] or [C] was pressed when no text was entered while using the Decorative Mode or Name Label function.
Line Limit!	You tried to enter a 3rd line by pressing [Enter]. You tried to print or preview two lines of text while 3.5 mm or 6 mm tape is installed. Install tape of a larger size.

Problem	Solution
The display stays blank after you have turned on the machine.	Check that the batteries are correctly inserted. If the batteries are weak, replace them. Check that the AC adapter (AD-24ES: Optional on the PT-D200) adapter is correctly connected.
When the label is printed out, the margin(space) is too large on both sides of the text.	See "Setting Margin" in this users guide and select [Half] or [Narrow] to have smaller margins for your label.
The machine does not print, or the printed characters are not formed properly.	Check that the tape cassette has been inserted correctly. If the tape cassette is empty, replace it. Check the cassette cover is properly closed.
The setting has cleared on its own.	The batteries may be weak. Replace them. When power is disconnected for more than three minutes, all text & formats in the display will be lost. Language and Unit settings will also be cleared.
A blank horizontal line appears through the printed label.	There maybe some dust on the print head. Remove the tape cassette and use a dry cotton swab to gently wipe the print head with an up-and-down motion. The print head can be cleaned more easily if the optional print head cleaning cassette (TZe-CL3) is used.
The power turns off when you try to print.	The batteries may be weak. Replace them. Check that the batteries are correctly inserted. A wrong adapter is used; the recommended adapter is the AD-24ES UK (Optional on the PT-D200).
The tape does not feed properly or the tape gets stuck inside the machine.	Check that the end of the tape feeds under the tape guides. The cutter lever is used while printing. Do not touch the cutter lever during printing.
All text and format settings need to be cleared to create a new label.	Press [C] + [C] and select [Text&Format].
The LCD is set to an incorrect language.	Refer to "Initial Settings".

Problem	Solution
The machine has "locked up" (i.e., nothing happens when a key is pressed, even though the machine is on.)	Refer to "Resetting the P-touch".
The power turns off when you try to print.	The batteries may be weak. Replace them. Check that the batteries are correctly inserted. A wrong adapter is used; the recommended adapter is the AD-24ES UK (Optional on the PT-D200).
The tape does not feed properly or the tape gets stuck inside the machine.	Check that the end of the tape feeds under the tape guides. The cutter lever is used while printing. Do not touch the cutter lever during printing.
All text and format settings need to be cleared to create a new label.	Press [C] + [C] and select [Text&Format].
The LCD is set to an incorrect language.	Refer to "Initial Settings".