

Quick Install Guide

4-Port USB 2.0 Hub



Thank you for purchasing the DUB-H4 4-Port USB 2.0 Hub. Follow the easy steps in this guide to properly set up your Hub. Please verify that all the package contents below are available.

Package Contents



DUB-H4 4-Port USB 2.0 Hub



Power Adapter



USB Cable

If any of the above items are missing, please contact your reseller.

System Requirements

- Windows® 7, Windows Vista®, Windows® XP SP2, or Windows® 2000 SP4
- Mac OS® X 10.4 or Higher
- USB 1.1 Port

DUB-H4

Panels

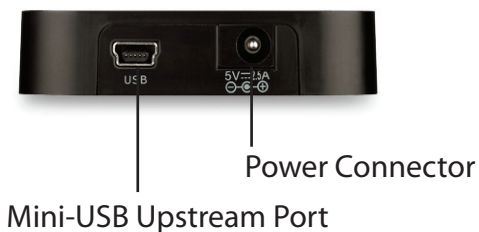
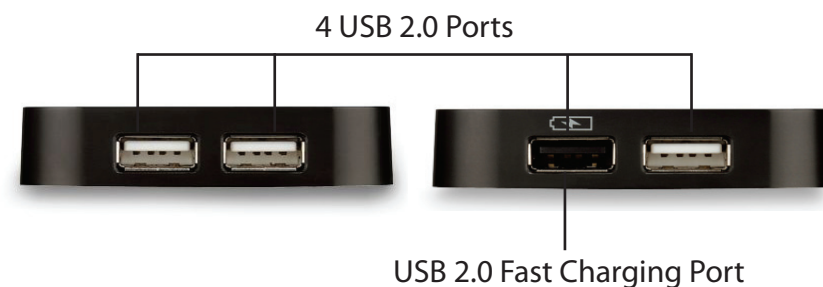

LED



The **Blue LED** will be ON when the Hub is NOT connected to a power adapter but connected to a computer only (Bus Power), and the Hub will deliver up to 0.5A of current per port.

The **Green LED** will be ON when the Hub is connected to a power adapter. When a USB device is connected, the USB fast charging port (Black Port) will deliver up to 2.0A of current. The three standard USB ports (White ports) will still provide up to 0.5A of current per port.

Installation

Step 1

Plug the power adapter into the power connector located on the back of the DUB-H4. Then, plug the other end into an AC power source.

Note: This step is optional, but is required if you need to charge your power hungry USB devices with the USB fast charging port on the DUB-H4.

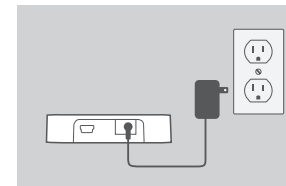

Step 2

Plug the smaller end of the included USB cable into the upstream port on the DUB-H4.

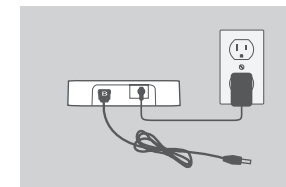

Step 3

Plug the rectangular end of the included USB cable into an available USB port on your computer.

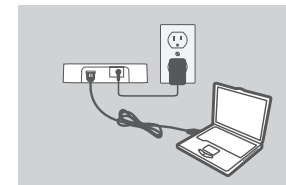

Step 4

Your computer will automatically detect and install the drivers for the DUB-H4. Once installed, you may plug in your USB devices.

The USB fast charging port provides high power while the power adapter is connected to the DUB-H4 (Green LED), allowing you to quickly charge your iPad®, iPhone®, tablets, and other mobile devices.

Note: Please refer to the **iPad® Charging** section for more details about charging your iPad with the DUB-H4.

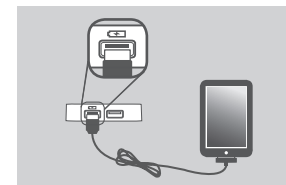

iPad® Charging

When the DUB-H4 is connected to a computer that is powered on, a connected iPad® may display the “Not Charging” status, but will be charging very slowly. You can quickly charge your iPad with the USB fast charging port on the DUB-H4 when:

- Computer is off
- Computer is in standby/sleep mode
- DUB-H4 is disconnected from your computer

Charging and Syncing Your iPad® At The Same Time (Windows® Only)

- If you want to charge and sync your iPad® simultaneously when it is connected via the DUB-H4 to a Windows computer, go to the Product Support page for the DUB-H4 (<http://www.dlink.com/support/>) to download and install the “iPad Charge” utility onto your computer.
- After successfully installed, a charger icon will appear in the taskbar.
- Now you’ll be able to sync and charge your iPad® at the same time with the fast charging port on the DUB-H4.

Note: The DUB-H4 must be connected to the power adapter to properly charge the iPad.

*iPad® and iPhone® are the registered trademarks of Apple Inc.

Technical Support

Having trouble installing your new product? D-Link’s website contains the latest user documentation and software updates for D-Link products. U.S. and Canadian customers can contact D-Link Technical Support through our website or by phone.

United States

Telephone: (877) 453-5465

Internet: <http://support.dlink.com>

Canada

Telephone: (800) 361-5265

Internet: <http://support.dlink.ca>

Copyright ©2011 All rights reserved. D-Link and the D-Link logo are registered trademarks of D-Link Corporation or its subsidiaries. Other trademarks are the property of their respective owners. Maximum transfer rate based on USB 2.0 specifications. Actual data throughput will vary. The total power consumption of the connected USB devices must be less than 2.0A. Using a USB 1.1 port will affect device performance. Product specifications, size and shape are subject to change without notice, and actual product appearance may differ from that depicted on the packaging. Visit dlink.com (US) or dlink.ca (Canada) for more details.

Version 3.0 (NA) | December 13, 2011 BMU0003A0126

D-Link®