

IS-DG102P Series

Rugged Industrial PoE injector, 1000BASE-TX PoE to 1000BASE-TX



The IS-DG102P Series are rugged designed, high power, Gigabit Ethernet industrial PoE Injector which meet IEEE 802.3af/at standard with 15.4/30/36 Watt high power output and are especially good for your security system application. The special cold design technology will not only power up your PD device, but also reduce the excessive heat problem to a minimum. The IS-DG102P-1 Series accept the input voltage from 46 to 57 VDC and have been rigorously tested for your Security, Transportation and all the other Industrial applications.



Key features

- ▶ 1 Giga TX and 1 Giga PoE port, (IEEE802.3af/at)
- ▶ PoE support up to 15.4/30/36 Watt
- ▶ Rugged design, compact enclosure
- ▶ Overload current protection
- ▶ Reverse power protection
- ▶ Provides increased noise immunity
- ▶ -40°C to 75°C operating temperature

Specification

Ethernet

Operating Mode	Store and Forward, L2 wire-speed/non-blocking switching engine
MAC addresses	1K
Packet Buffer	1 Mbits
Jumbo frame	9K

RJ45 Copper ports

Speed	10/100/1000 Mbps
MDI/MDIX Auto-crossover	Support straight or cross wired cables
Auto-negotiation/Duplex	10/100/1000 Mbps speed auto-negotiation; Full & Half Duplex

PoE Ports

Output Power	IEEE 802.3af/at, 15.4/30/36 Watt output
--------------	---

Power

Power Input	Redundant Power Input, DC Input, terminal Block
Input Voltage Range	46-57 VDC *12/24 VDC power input or 60W Ultra PoE output version are also available, please contact sales for the detailed.
Reverse power protection	YES
Power Consumption	IS-DG102P-1, Max 1.5 Watt

Indicators

Power status indication	Power Input status
Ethernet port indication	Link & speed

Environmental and Compliances

Operating Temperature	-40~75°C (Cold startup at -40°C)
Storage Temperature	-40~85°C
Humidity	5~95% (Non-Condensing)
Vibration, shock, free fall	IEC-60068-6, -27, -32
Certification Compliance	CE, FCC
Electrical safety	CE

EMC	FCC Part 15, CISPR 22 (EN55022) Class A IEC-61000-4-2, -3, -4, -5, -6 (Level 3)
RoHS & WEEE	RoHS (Pb free) and WEEE Compliant
MTBF	>25 years

Mechanical

Protection	IP30
Dimension	103.5mmx32mmx81.5mm (LxWxD) (without DIN rail kit)
Weight	140 g
Installation	DIN-Rail mounting; Wall mounting
DIP	1A, 24V, Normal Open

Dimension Diagram

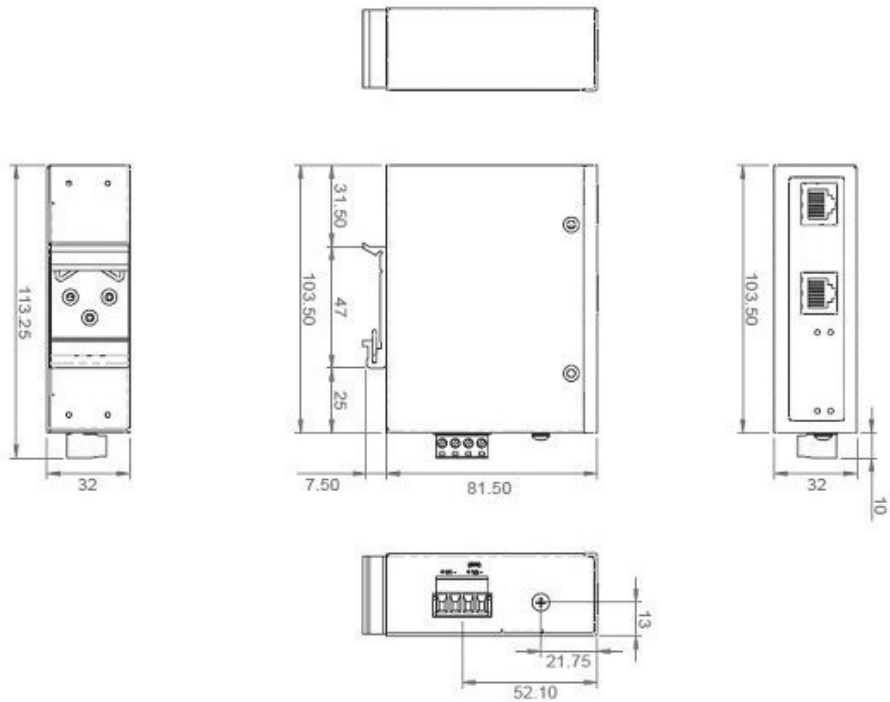

Ordering Information

Available Models	Description	10/100/1000Mb TX	100/1000Mb PoE
IS-DG102P-1	Industrial 2 port Gigabit Layer 2 PoE injector	1	1

Accessories

N/A