

# NYRIUS

## USER GUIDE

---

### ARIES™ Pro Wireless HD for Laptops

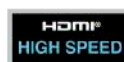

**NPCS550**

**[www.NYRIUS.com](http://www.NYRIUS.com)**

Thank you for your purchase of this Nyrius product. Please read this instruction manual carefully before using product to ensure proper use. Keep this manual in a safe place for future reference.

# TABLE OF CONTENTS

<b>What's Included</b> .....	2
<b>Buttons and Connections</b> .....	3
<b>Setup</b> .....	5
Setting up the Receiver.....	5
Connecting the Receiver .....	5
Connecting the Transmitter .....	6
Connecting Multiple Transmitters With One Receiver.....	7
Renaming a Video Source .....	7
Selecting a video source .....	9
Removing a video source .....	9
Standby Mode .....	10
Windows OS Audio setting to switch to HDMI output .....	10
<b>Troubleshooting</b> .....	12
<b>Specifications</b> .....	13
<b>FCC Statement</b> .....	14
<b>Safety Information</b> .....	15
<b>NYRIUS Warranty</b> .....	17

## WHAT'S INCLUDED

- Digital Wireless HD Transmitter
- Digital Wireless HD Receiver
- Mounting Bracket for Receiver
- Velcro® STRIPS
- External IR Receiver
- Remote Control
- 100-240V AC Power Adapter
- 5 ft HDMI Cable
- Right Angle HDMI Adapter
- USB Power Cable
- Female USB Adapter
- Instruction Manual
- 1 Year Warranty
- Lifetime Customer Support

### Disclaimers

- HDMI is a registered trademark of HDMI Licensing LLC.
- Maximum transmission range is 160ft under clear line of sight. When transmitting through walls, floors or ceilings the range will decrease depending on the environment.
- Bluetooth is a registered trademark of Bluetooth SIG Inc. Wi-Fi is a registered trademark of Wi-Fi Alliance.
- Dolby is a registered trademark of Dolby Laboratories Licensing Corporation.
- Playstation is a registered trademark of Sony Computer Entertainment Inc. Xbox is a registered trademark of Microsoft Corporation.
- Nyrius®, the Nyrius® logo, ARIES™ and any other Nyrius® marks may be registered. All other trademarks are property of their respective owners.

# BUTTONS AND CONNECTIONS

## Transmitter



1. **VIDEO LED** - Indicates HDMI Connection
2. **SYNC BUTTON** - Synchronizes receiver and transmitter
3. **NETWORK LED** - Indicates wireless connection
4. **USB INPUT** - For USB Power Connection

## Receiver



5. **SYNC BUTTON** - Synchronizes receiver and transmitter
6. **VIDEO LED** - Indicates HDMI connection
7. **NETWORK LED** - Indicates wireless connection
8. **HDMI OUTPUT** - Connect your HDMI device
9. **IR EXTENDER INPUT** - Detects IR commands
10. **USB INPUT** - For HID features
11. **5V DC POWER INPUT** - Connect to power supply

# BUTTONS AND CONNECTIONS

## Remote Control

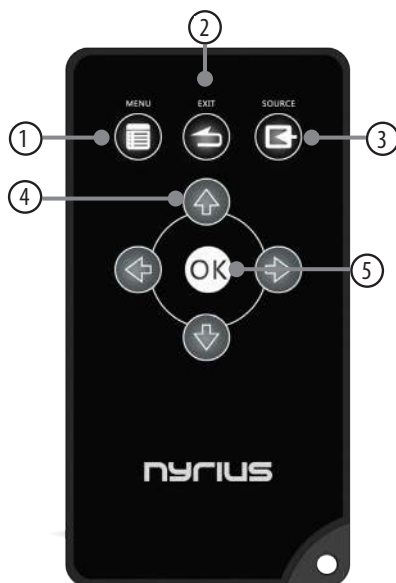

1. **MENU** – Enter the main menu
2. **EXIT** – Return to previous menu
3. **SOURCE** – Select video source
4. **DIRECTIONAL KEYS** – To Toggle UP/DOWN/LEFT/RIGHT in the menu screen
5. **OK** – Confirm your selection

# SETUP

**DC IN** - Connect the 5V/2A power adapter ( spec: 3.5mm, DC 5V ) to this port.

**HDMI OUT**- Using the HDMI cable provided, connect the receiver to the HDMI Input of any HD display device (HDTV, projector).

**MINI USB INPUT PORT** - HID Remote Control function is supported when it is connected to the mini USB input port of a mouse or keyboard.

**SYNC BUTTON** - Press the Sync Button button for 5 seconds , the receiver will begin to connect.

## Network Status Indicator -

**ON**:The wireless network connection between the transmitter and receiver successful.

**FLASH SLOWLY**: Transmitter is ready to connect.

**FLASH RAPIDLY**: The device is not connecting.

## Video indicator -

**ON**: The video source connection is successful.

**OFF** : The video source has failed to connect.

**IR Sensor** - The remote control is aligned to the IR Extender Input of receiver when using.

## SETTING UP THE RECEIVER

1. Install the mounting bracket to the bottom of the receiver by lining up the mounting hole with the screw on the top of the mounting bracket. Rotate the screw on the mount clockwise until until it is secure.
2. Set the receiver to the proper angle and tighten it into place by turning the knob on the side of the mount clockwise until it is secure.

## CONNECTING THE RECEIVER

1. Connect the receiver to the monitor using the HDMI cable, plug the IR Extender into the IR input of receiver.
2. Wait for 5 to 10 seconds, the network and video indicators will light up, confirming that the Basic Function video connection is successful.

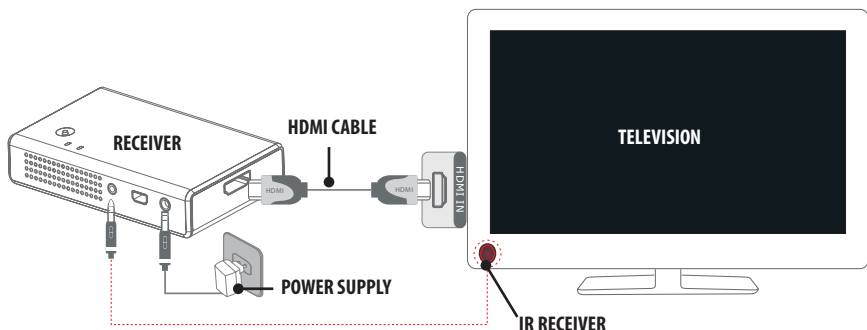

# SETUP

## CONNECTING THE TRANSMITTER

1. Connect the Transmitter to the PC / Laptop using the USB cable and the HDMI Input.
2. Wait for 5 to 10 seconds, the network and video indicators will light up, confirming that the Basic Function video connection is successful. The information on the screen will show "Connected to NYRIUS..." and display the video source content from the PC/ Laptop.

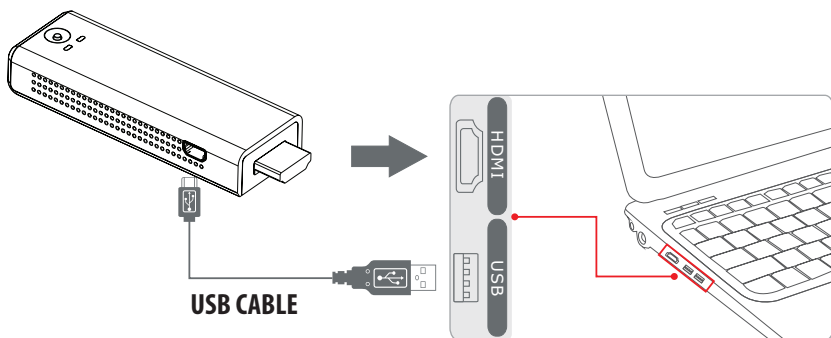

**The network indicator won't light up unless connection is established with transmitter**

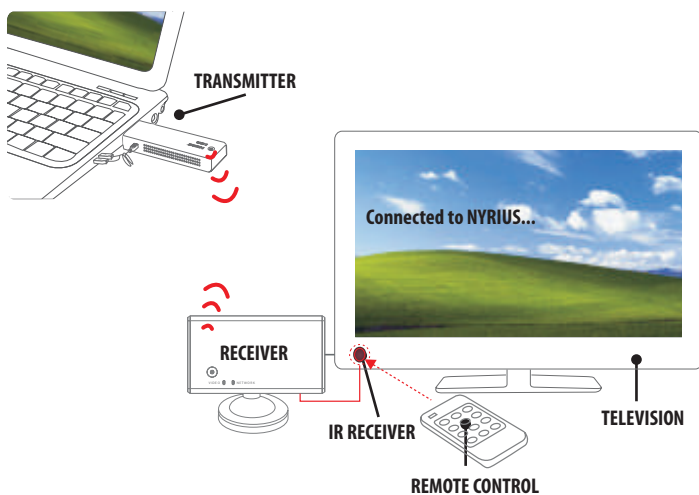

# SETUP

Multicast function means that a receiver can be connected to many transmitters, (up to 8 transmitters) by using the remote control.

## Connecting multiple transmitters with one receiver

1. Press the [MENU] key of the remote control to enter the MAIN MENU, press the directional keys to select [Add new Video Source] to add a video source. Please be sure that the remote control is pointing to the receiver's IR sensor.

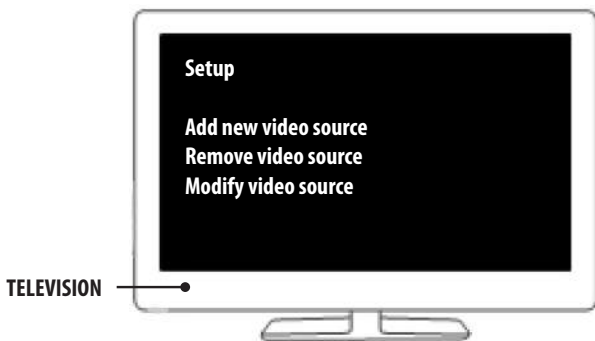

2. "Please Activate Registration On Transmitter Unit" will appear on the screen. Press the SYNC BUTTON on the transmitter for 3~5 seconds to establish a connection.
3. Press the [OK] button to confirm adding the new video source. The new video source will be connected after approximately 30 seconds.
4. To add more than one video source, please repeat steps 1-3.

## Renaming a video source

When adding multiple transmitters, it is recommended to add each transmitter one at a time and rename each one to avoid any confusion when selecting a video source.

1. Press the [MENU] button on the remote and select "Modify Video Source" from main menu.

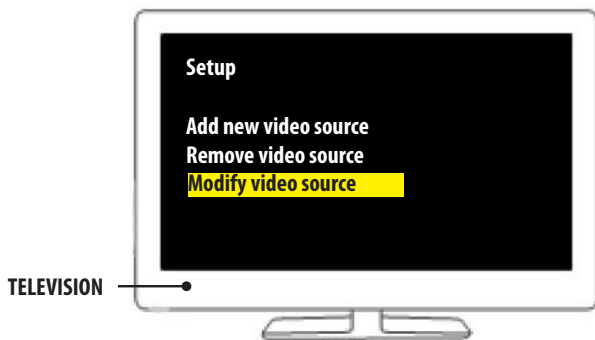

# SETUP

2. Select the video source to rename and press [OK] to confirm your selection.

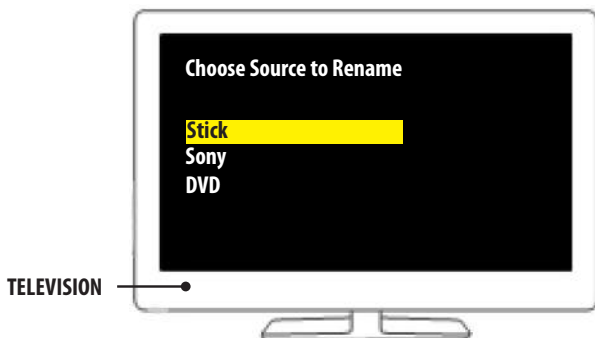

3. Use [LEFT ][RIGHT ][UP][DOWN] direction keys to modify the name of the video source and press [OK] when you are done.

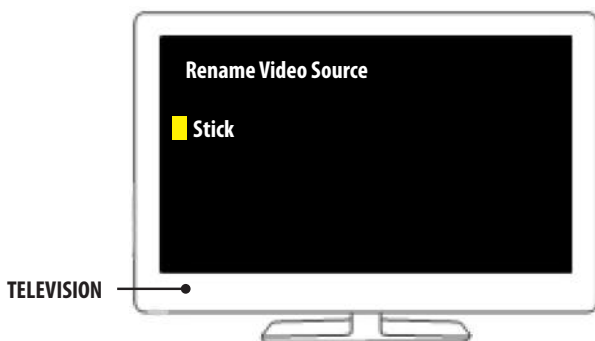



# SETUP

## Selecting a video source

1. Press the [SOURCE] button on the remote to display the list of video sources to choose from.
2. Use the [UP] / [DOWN] directional keys to select a video source. Press [OK] to confirm your selection.

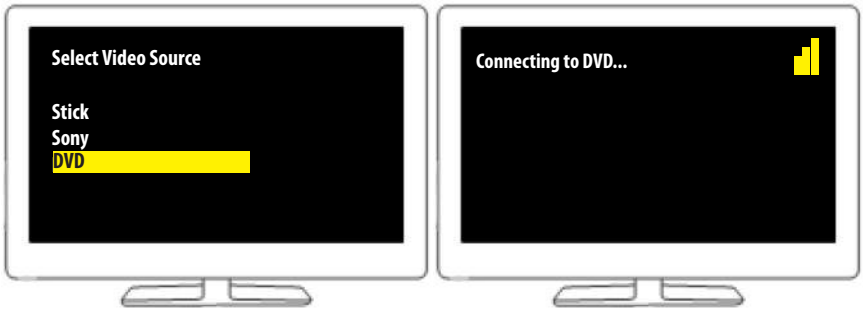

## Removing a video source

1. Press the [SOURCE] button on the remote to display the list of video sources to choose from.
2. Use the [UP] / [DOWN] directional keys to select [REMOVE VIDEO SOURCE] on the main menu.
3. Use the [UP] / [DOWN] directional keys to select a video source.
4. Press [OK] to delete.

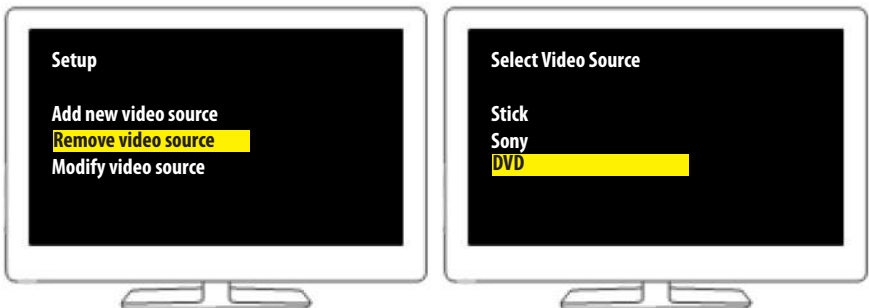

# SETUP

## Standby Mode

1. When the receiver's signal is disconnected from the transmitter, the system will go into Standby Mode and the OSD will display "Wireless Off".
2. Press [SOURCE] or [MENU] to return to the main menu.

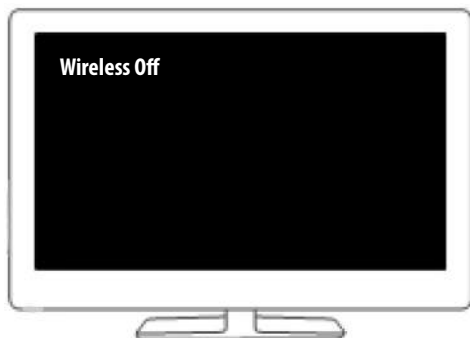

## Changing Audio Output to TV

Windows OS Audio setting to switch to HDMI output:

Windows7 OS:

1. Go to START MENU in bottom left corner of screen. Click **Control Panel --> Hardware and Sound --> Sound --> Playback** to open AUDIO SETTINGS.
2. Select HDMI OUTPUT ① and Press OK ②.

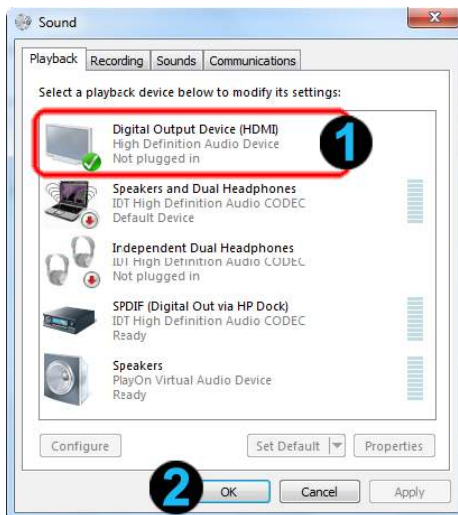

WindowsXP OS:

1. Go to START MENU in bottom left corner of the screen. Click CONTROL PANEL to open AUDIO setting.
2. Select HDMI OUTPUT and Press OK.

# SETUP

Windows Vista OS:

1. Go to **START MENU** ① in bottom left corner of the screen. Click **WINDOWS MOBILITY CENTER** ② to open.
2. On the **VOLUME** ③ tab, click the **CHANGE AUDIO SETTING** ④ icon to open the **SOUND** section.
3. Select **HDMI OUTPUT** ⑤ and press **OK** ⑥.



# TROUBLESHOOTING

Before following the troubleshooting guide below please make sure that your Transmitter, Receiver and attached equipment (HD source and display) are all properly connected switched on and not in Standby Mode.

No Video	<ul style="list-style-type: none"> <li>• Check the status of the Link LEDs, and check if the HD device is working normally</li> <li>• Check the HDMI cable is undamaged and is plugged into the correct socket</li> <li>• Check that the correct HDMI output has been selected from the HD device's menu and that the HDMI cable is plugged into the correct output socket</li> <li>• Check that the correct HDMI input has been selected from the TV menu and that the HDMI cable is plugged into the input socket selected</li> <li>• Make sure that it is the Receiver that is connected to the HDTV display, and the Transmitter that is connected to your HD device</li> </ul>
Power LED OFF	<ul style="list-style-type: none"> <li>• Make sure the power is connected, and check the power adaptor output to the Receiver is 5V/2A DC</li> </ul>
Video LED OFF	<ul style="list-style-type: none"> <li>• Check the HD device is powered on</li> <li>• Make sure the HD device is on, connected to the HDMI socket and outputting a supported resolution. The Video LED will switch OFF if an unsupported video signal is output</li> <li>• Part of the system is not properly connected or the signal received is not of good enough quality/strength</li> <li>• Make sure the HD display is connected, switched ON and set to the right channel/input (e.g. HDMI channel)</li> <li>• Check the HDMI cable is undamaged and is plugged into the correct socket</li> </ul>
Network LED Flashes	<ul style="list-style-type: none"> <li>• Make sure the Transmitter and Receiver are not positioned too far apart. Move them closer together to check minimum effective range. Make sure the HD device is switched ON and had been connected to Receiver</li> </ul>
Bad Picture	<ul style="list-style-type: none"> <li>• Make sure the HDMI cable used are undamaged and that you can get a good picture when the source is connected directly to the display with an HDMI cable</li> <li>• Make sure nothing is touching or blocking the signal to the built in antennas</li> <li>• Move Transmitter and Receiver closer together</li> <li>• Restart the HD device or reconnect the HDMI cable</li> </ul>
Bad Audio/No Audio	<ul style="list-style-type: none"> <li>• Make sure that the source is outputting supported audio formats</li> <li>• If the audio signal drops out, restart the audio source and reconnect the HDMI cable</li> <li>• Make sure there is no 5.8GHz wireless phone within 50cm of the Receiver. Some phones use substandard transmission schemes</li> </ul>
Other Issues/Unresolved Issues	<ul style="list-style-type: none"> <li>• If any other issue occurs or if the above issues persist, try disconnecting both Transmitter and Receiver and repeating the link setup process</li> </ul>

For further questions or inquiries, please contact **NYRIUS** customer support at:

**[www.nyrius.com/support](http://www.nyrius.com/support)**

# SPECIFICATIONS

Wireless Technology	GigaXtreme Technology
System Requirements	Any laptop or desktop system containing an HDMI port including popular models from these manufacturers: Alienware, Lenovo, Dell, HP, Acer, Apple (Display Port cable not included)
Supported Audio Resolutions	PCM , DTS , Dolby Digital 5.1 surround sound
Supported Video Resolutions	TV: 1080p, 1080i, 720p, 576p, 480p PC: 1024x768, 1280x1024, 640x480, 800x600
Ports and Interfaces	HDMI
Wireless Range	160ft Clear Line of Sight
Transmission Frequency	5.15~ 5.25GHz, 5.725~ 5.85GHz
Bandwidth	20MHz /40MHz
System Latency	< 1 ms
Antenna	PCB antenna
Standard Protocol	HDMI 1.3
Power supply	5V1A (for Transmitter) 5V2A (for Receiver)
Working temperature	-10°C to 40 °C
Storage temperature	-20° to 80° C
Dimensions (Transmitter)	98 (L) x 29 (W) x 14.5mm(H)
Dimensions (Receiver)	99 (L) x 56 (W) x 20.5mm(H)

# FCC STATEMENT



This device complies with part 15 of the FCC rules. Operation is subject to the following two conditions:

- (1) this device may not cause harmful interference, and
- (2) this device must accept any interference received, including interference that may cause undesired operation.

## **WARNING:**

This equipment has been tested and is found to comply with the limits for a Class B digital device, pursuant to Part 15 of the FCC Rules. These limits are designed to provide reasonable protection against harmful interference in a residential installation. This equipment generates, uses and can radiate radio frequency energy and, if not installed and used in accordance with the instructions, may cause harmful interference to radio communications. However, there is no guarantee that interference will not occur in a particular installation. If this equipment does cause harmful interference to radio or television reception, which can be determined by turning the equipment off and on, the user is encouraged to try to correct the interference by one or more of the following measures:

- Reorient or relocate the receiving antenna
- Increase the separation between the equipment and receiver
- Connect the equipment into an outlet on a circuit different from that to which the receiver is connected
- Consult the dealer or an experienced radio/TV technician for help

## **WARNING:**

Changes or modifications not expressly approved by the party responsible for compliance with the FCC Rules could void the user's authority to operate this equipment.

## **IC STATEMENT / CAN ICES-3 (B)/NMB-3(B)**

Operation is subject to the following two conditions: (1) This device may not cause interference, and (2) This device must accept any interference, including interference that may cause undesired operation of the device.



## **DO NOT INGEST BATTERY, CHEMICAL BURN HAZARD**

This product contains a coin/button cell battery. If the coin/button cell battery is swallowed, it can cause severe internal burns in just 2 hours and can lead to death.

Keep new and used batteries away from children. If the battery compartment does not close securely, stop using the product and keep it away from children.

If you think batteries might have been swallowed or placed inside any part of the body, seek immediate medical attention.

# SAFETY INFORMATION

1. Read all instructions.
2. Keep these instructions.
3. Heed all warnings.
4. Follow all instructions.
5. Do not use this apparatus near water.
6. Clean only with a dry cloth.
7. Do not block any ventilation openings. Install in accordance with the manufacturer's instructions.
8. Do not install near any heat sources such as radiators, heat registers, stoves, or other apparatus (including amplifiers) that produce heat.
9. Do not defeat the safety purpose of the polarized or grounding-type plug. A polarized plug has two blades with one wider than the other. A grounding type plug has two blades and a third grounding prong. The wide blade or the third prong are provided for your safety. If the provided plug does not fit into your outlet, consult an electrician for replacement of the obsolete outlet.
10. Protect the power cord from being walked on or pinched particularly at plugs, convenience receptacles, and the point where they exit from the apparatus.
11. Only use attachments/accessories specified by the manufacturer.
12. Unplug this apparatus during lightning storms or when unused for long periods of time.
13. Refer all servicing to qualified service personnel. Servicing is required when the apparatus has been damaged in any way, such as power-supply cord or plug is damaged. Liquid has been spilled or objects have fallen into the apparatus, the apparatus has been exposed to rain or moisture, does not operate normally, or has been dropped.
14. Apparatus shall not be exposed to dripping or splashing, and that no objects filled with liquids, such as vases, shall be placed on the apparatus.
15. The battery shall not be exposed to excessive heat such as sunshine, fire or the like.
16. The direct plug-in adapter is used as disconnect device, the disconnect device shall remain readily operable.
17. **WARNING:** To reduce the risk of fire or electric shock, do not expose this apparatus to rain or moisture.



Waste electrical and electronic products should not be disposed of with household waste. Please recycle where facilities exist. Check with your Local Authority for recycling advice.

# SAFETY INFORMATION

Do not use close to refrigerators, washing machines and metal furniture. Place on a stable surface and make sure connecting wires are routed to minimize the chance of accidents.

Only use the DC power adaptors supplied, if they must be replaced make sure the replacements have the same output rating of 5V 2A DC.

Avoid exposing your equipment to harsh conditions such as wet or damp places, high humidity, strong vibration, extremely high or low temperatures, strong sunlight and places that are very dusty.

Do not cover or place heavy objects on the units. Make sure there is sufficient clearance around the units to allow adequate ventilation.

Never push objects into holes or ventilation slots.

To save power turn OFF the switches on the power adaptor leads or unplug the power adaptors from the power sockets when you are not using the equipment.

Don't continue to use any part of this equipment if you have spilled liquids on it, if it is damaged in any way or if it does not work normally. Immediately unplug the equipment and get expert advice.

Cleaning: disconnect the main power supply and use only a lightly dampened cloth. Do not use chemical solvents or strong detergents as these may damage the cosmetic finish.

- To prevent electric shock, do not remove any cover.
- If anything goes wrong, do not try to repair yourself, get a qualified engineer to look at it.
- Do not expose this equipment to dripping or splashing liquids.
- Never allow a naked flame on or near the equipment.
- This product is not a toy. Do not let young children play with the equipment.



# WARRANTY

Thank you for choosing NYRIUS® Consumer Electronics Products!

NYRIUS gives the following express warranty to the original consumer purchaser or gift recipient for this NYRIUS product, when shipped in its original container and sold or distributed by NYRIUS or by an Authorized NYRIUS Dealer: NYRIUS warrants that this product is free, under normal use and maintenance, from any defects in material and workmanship. If any such defects should be found in this product within the applicable warranty period, NYRIUS shall, at its option, repair or replace the product as specified herein. Replacement parts furnished in connection with this warranty shall be warranted for a period equal to the unexpired portion of the original equipment warranty.

This warranty shall not apply to:

- A. Any defects caused or repairs required as a result of abusive operation, negligence, accident, improper installation or inappropriate use as outlined in the owner's manual.
- B. Any NYRIUS product tampered with, modified, adjusted or repaired by any party other than NYRIUS or NYRIUS's Authorized Service Centres.
- C. Damage caused or repairs required as a result of the use with items not specified or approved by NYRIUS including but not limited to head cleaning tapes and chemical cleaning agents.
- D. Any replacement of accessories, glassware, consumable or peripheral items required through normal use of the product including but not limited to earphones, remote controls, AC adapters, batteries, stylus, trays, filters, cables, paper, cabinet, cabinet parts, knobs, buttons, baskets, stands and shelves.
- E. Any cosmetic damage to the surface or exterior that has been defaced or caused by normal wear and tear.
- F. Any damage caused by external or environmental conditions, including but not limited to transmission line/power line voltage or liquid spillage.
- G. Any product received without appropriate model, serial number and CSA /cUL /cULus /cETL /cETLus markings.
- H. Any products used for rental or commercial purposes.
- I. Any installation, setup and/or programming charges.

Should this NYRIUS product fail to operate during the warranty period, warranty service may be obtained upon delivery of the NYRIUS product together with proof of purchase and a copy of this LIMITED WARRANTY statement to an Authorized NYRIUS Service Centre. In-home warranty service may be provided at NYRIUS discretion on any NYRIUS television with the screen size of 40" or larger. This warranty constitutes the entire express warranty granted by NYRIUS and no other dealer, service centre or their agent or employee is authorized to extend, enlarge or transfer this warranty on behalf of NYRIUS. To the extent the law permits, NYRIUS disclaims any and all liability for direct or indirect damages or losses or for any incidental, special or consequential damages or loss of profits resulting from a defect in material or workmanship relating to the product, including damages for the loss of time or use of this NYRIUS product or the loss of information. The purchaser will be responsible for any removal, reinstallation, transportation and insurance costs incurred. Correction of defects, in the manner and period of time described herein, constitute complete fulfillment of all obligations and responsibilities of NYRIUS Electronics to the purchaser with respect to the product and shall constitute full satisfaction of all claims, whether based on contract, negligence, strict liability or otherwise.

## 1 YEAR PARTS & LABOUR WARRANTY PERIODS

TO OBTAIN THE NAME AND ADDRESS OF THE NEAREST AUTHORIZED NYRIUS SERVICE CENTRE OR FOR MORE INFORMATION ON THIS WARRANTY

Contact NYRIUS Support:

- **Support:** [www.nyrius.com/support](http://www.nyrius.com/support)
- **Website:** [www.nyrius.com](http://www.nyrius.com)
- **By mail:** NYRIUS Customer Service, 4080 Montrose Road, Niagara Falls, ON L2H 1J9